

VisiClear®

Surgical Smoke Evacuator

Quick-View Set-Up

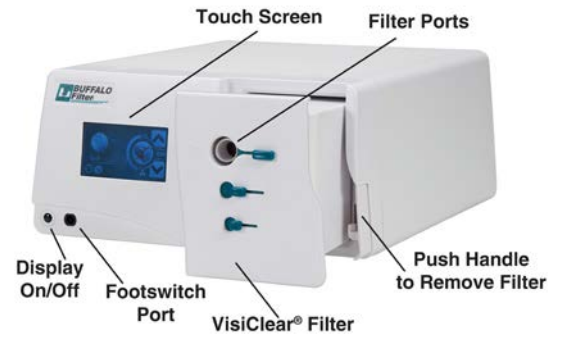

Instructions

Plug in surgical smoke evacuator to activate touch screen control panel. Should the surgical smoke evacuator go into sleep mode, press the Display On/Off button to reactivate touch screen control panel.

Three (3) Modes of Operation

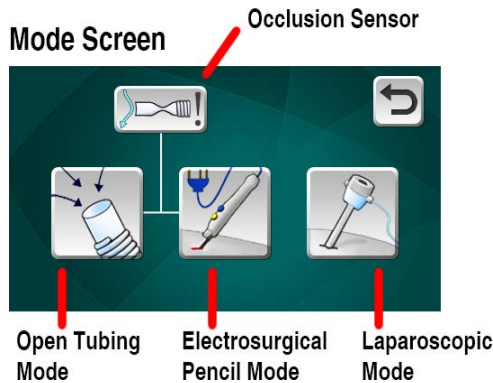

Open Tubing Mode

- Select Open Tubing Mode from touch screen
- Connect tubing to appropriate port on filter
- Adjust suction setting as needed (default is 80%)

Electrosurgical Pencil Mode

- Select Electrosurgical Pencil Mode from touch screen
- Plug pencil wire into electrosurgical generator
- Insert smoke evacuation tubing into appropriate filter port
- Adjust suction setting as needed (default is 80%)
- For use of Buffalo Filter EZLink® please refer to product Directions for Use (DFU) for set-up instructions

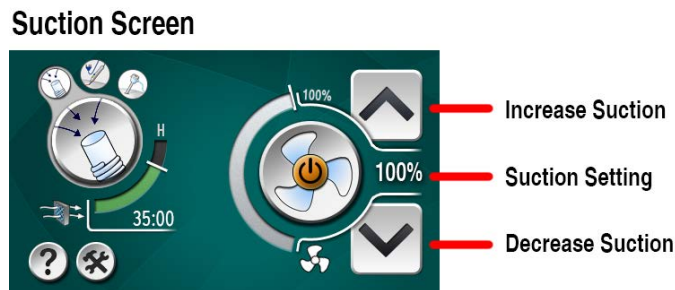

Laparoscopic Mode

- Select Laparoscopic Mode from touch screen
- Suction is pre-set to lowest possible setting (default is 10%)
- Connect laparoscopic smoke evacuation tubing to appropriate port
- Connect tubing to trocar on the highest elevated side of operative site to prevent fluid aspiration. Do not connect to trocar used for camera.
- Open trocar stop cock once cautery begins

